

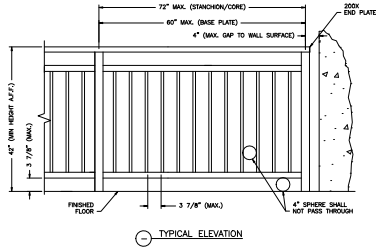

WORLD CLASS ARCHITECTURAL PRODUCTS

HANSEN ARCHITECTURAL SYSTEMS

4860 NW SHUTE ROAD
HILLSBORO, OR 97124
PHONE 503.356.0959
FAX 503.356.8478
WWW.ALUMINUMRAILING.COM



TYPICAL ELEVATION

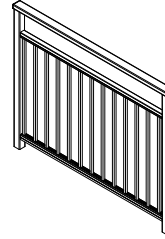

TYPICAL ISOMETRIC

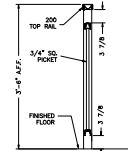

TYPICAL SECTION

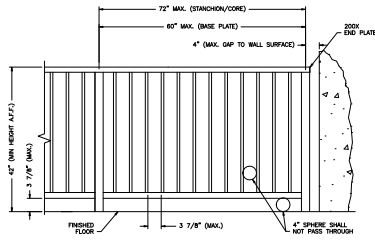

TYPICAL ELEVATION

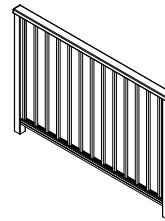

TYPICAL ISOMETRIC

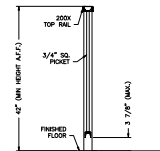

TYPICAL SECTION

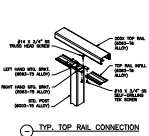

TYP. TOP RAIL CONNECTION

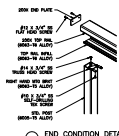

END CONDITION DETAIL

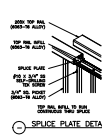

SPLICE PLATE DETAIL

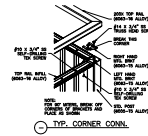

TYP. CORNER CORN.

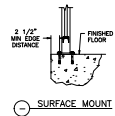

SURFACE MOUNT

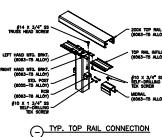

TYP. TOP RAIL CONNECTION

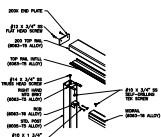

END CONDITION DETAIL

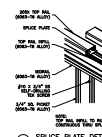

SPLICE PLATE DETAIL



TYP. CORNER CORN.

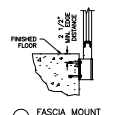

FASCIA MOUNT

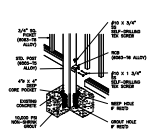

POST ONLY CORE POCKET DETAIL

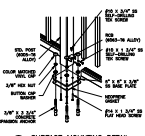

SURFACE MOUNTING DETAIL

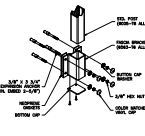

FASCIA MOUNTING DETAIL

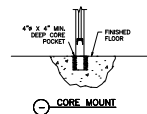

CORE MOUNT

SERIES 200X WITH MIDRAIL PICKET RAILING SYSTEM

THE INFORMATION CONTAINED IN THIS DRAWING IS THE SOLE PROPERTY OF HANSEN ARCHITECTURAL SYSTEMS, INC. ANY REPRODUCTION IN PART OR AS A WHOLE WITHOUT THE WRITTEN PERMISSION OF HANSEN ARCHITECTURAL SYSTEMS, INC. IS PROHIBITED.