

(SEE FASTENER
SHEET— "2FSTN-01A"
THROUGH "2FSTN-01D"
FOR FASTENING
APPLICATION)

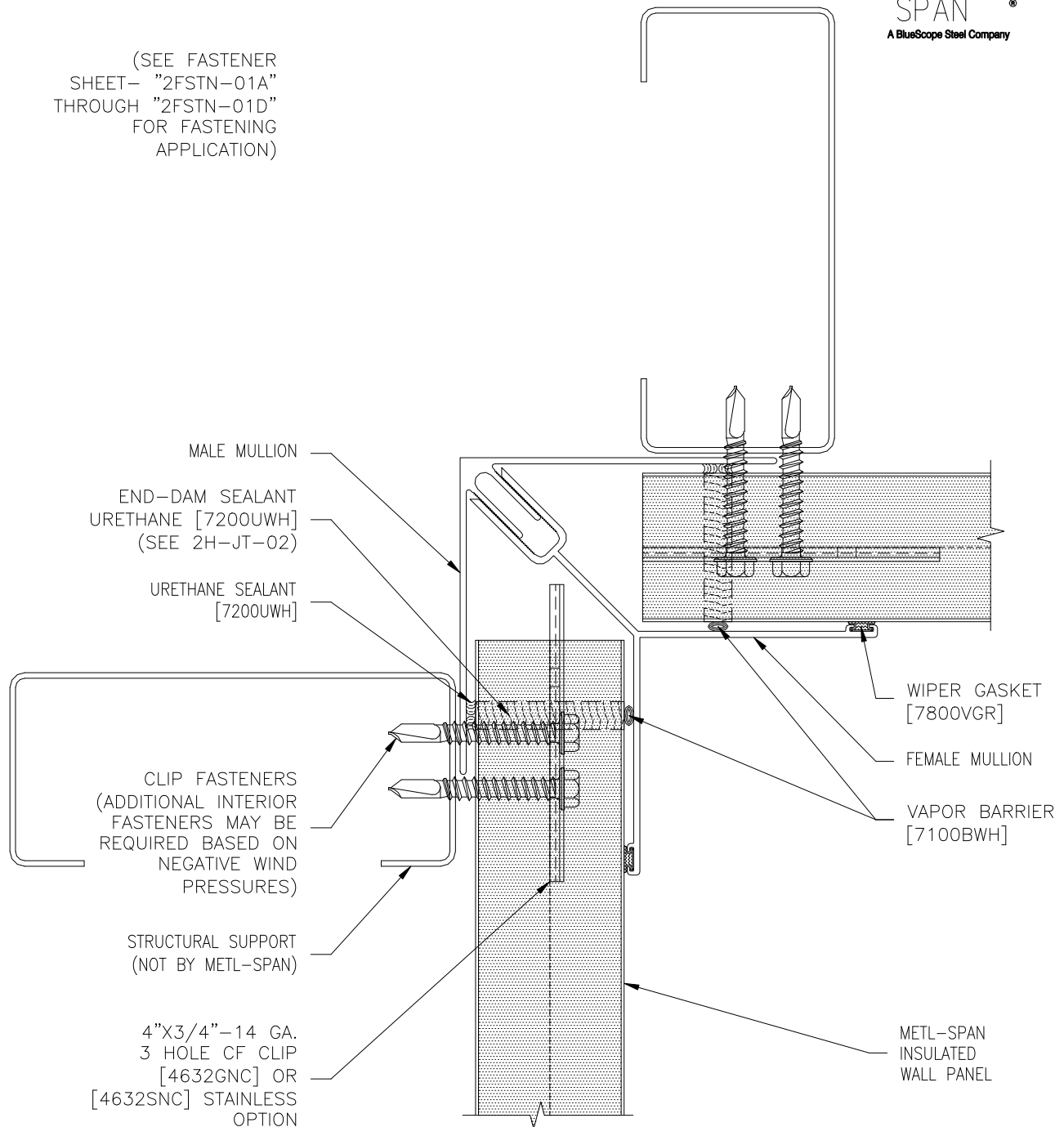

REFER TO SHEET "CI-INFO" FOR ADDITIONAL INFORMATION REGARDING THE
APPLICATION OF SEALANTS, FASTENERS, AND CLOSURE MATERIALS.
CONSULT METL-SPAN TO DETERMINE ALLOWABLE LOAD AND SPACING OF ATTACHMENT FASTENERS.

**C&I HORIZONTAL
EXTRUDED
INSIDE CORNER DETAIL**

**APPLICATION:
COMMERCIAL & INDUSTRIAL**

2H-EC-02

DATE: DECEMBER 19, 2008