

SAF Series M-1000 ALUMINUM
VERTICAL BUTT JOINT DETAIL

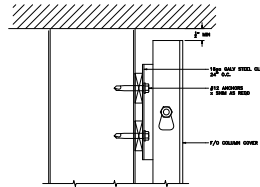

SAF Series M-1000 ALUMINUM
CEILING/SOFFIT DETAIL

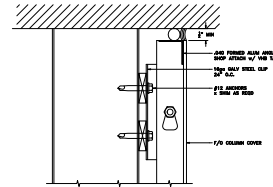

SAF Series M-1000 ALUMINUM
CEILING/SOFFIT DETAIL

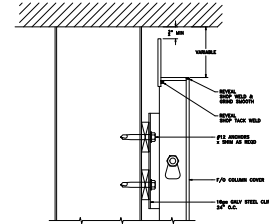

SAF Series M-1000 ALUMINUM
CEILING/SOFFIT DETAIL

THIS DETAIL NOT AVAILABLE ON ANODIZED COVERS

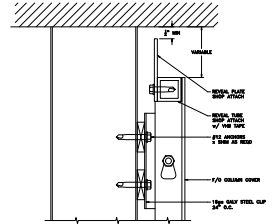

SAF Series M-1000 ALUMINUM
CEILING/SOFFIT DETAIL

USE THIS DETAIL ON ANODIZED COVERS

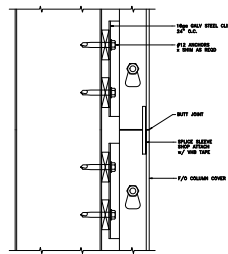

SAF Series M-1000 ALUMINUM
STACK JOINT DETAIL

Note: This detail recommended for prefinished materials only. Post finishing will result in gaps at the reveal due to warping.

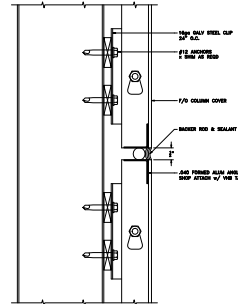

SAF Series M-1000 ALUMINUM
STACK JOINT DETAIL

SAF recommends against a horizontal butt-joint on post-painted metal due to warping. We recommend installing with a horizontal caulk joint as shown above.

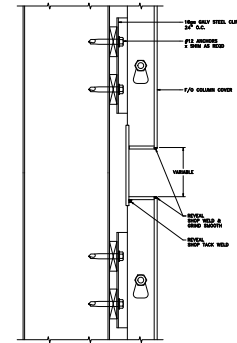

SAF Series M-1000 ALUMINUM
STACK JOINT DETAIL

THIS DETAIL NOT AVAILABLE ON ANODIZED COVERS

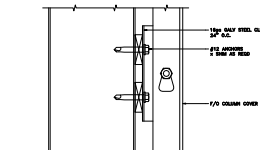

SAF Series M-1000 ALUMINUM
BASE DETAIL

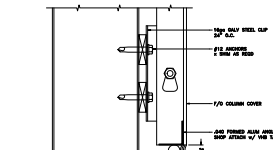

SAF Series M-1000 ALUMINUM
BASE DETAIL

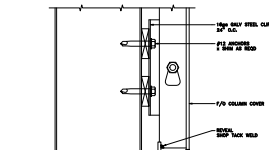

SAF Series M-1000 ALUMINUM
BASE DETAIL

THIS DETAIL NOT AVAILABLE ON ANODIZED COVERS

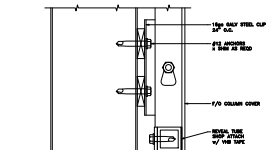

SAF Series M-1000 ALUMINUM
BASE DETAIL

USE THIS DETAIL ON ANODIZED COVERS